

Acer – Pairing Your Wireless Keyboard

(Please do this at home. Your tablet may pick up multiple Bluetooth keyboards if done with other students)

1. Unwrap your keyboard / cover
2. Insert your tablet into the keyboard cover
3. Insert your power adapter into the tablet

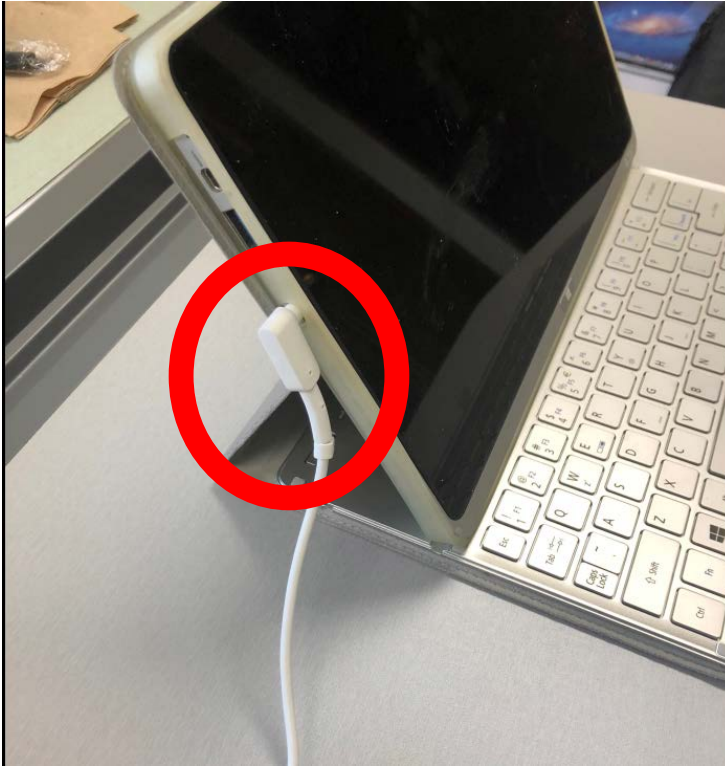

4. Locate the USB cable in your accessories box



5. Connect the large end of the USB cable from your accessories box to the USB port on the left



6. Connect the small end of the USB cable to the mini USB port on your keyboard



7. Power on tablet
8. Login into your student account
9. Swipe from the right of the screen on the tablet to bring up the Action Center menu

10. Tap all Settings

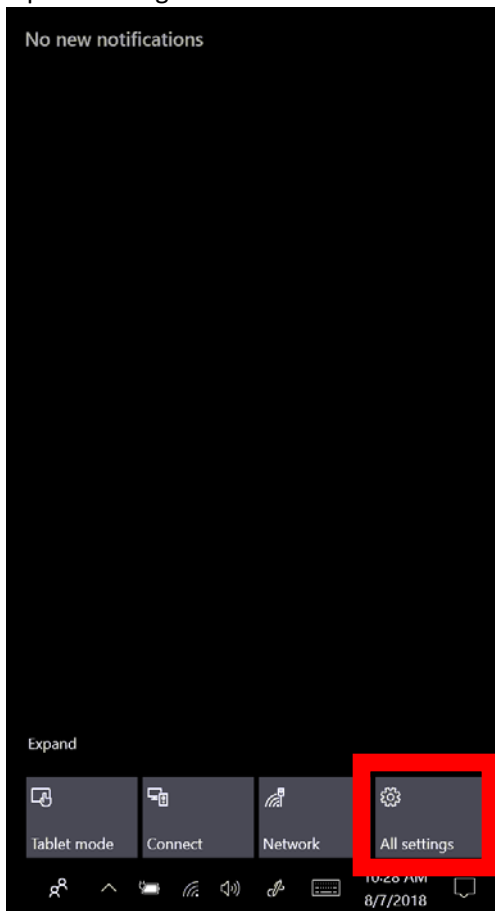

11. Tap Devices

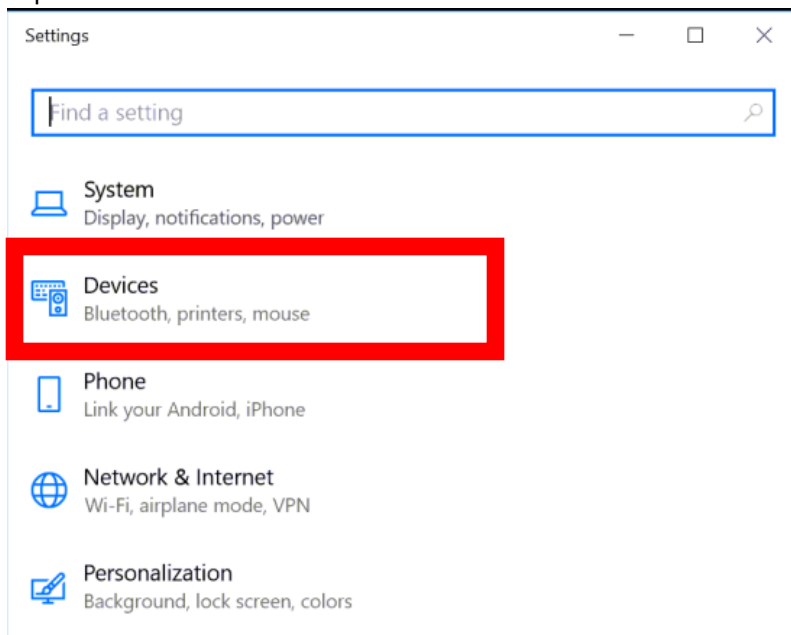

12. Tap Bluetooth & other devices

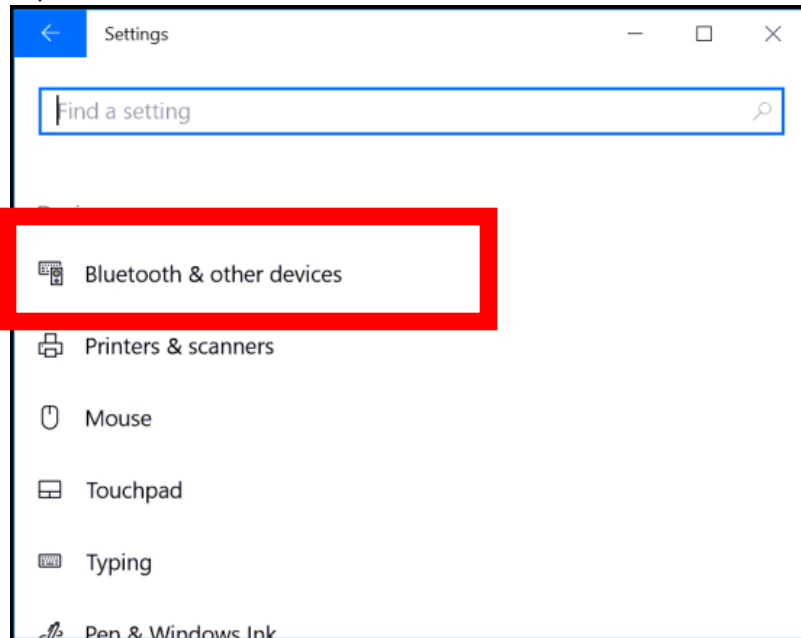

13. Tap Add Bluetooth or other device

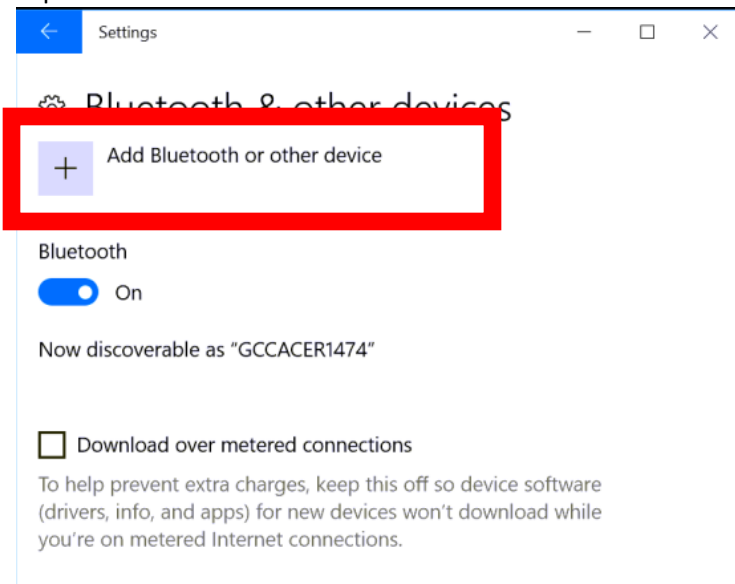

14. Tap Bluetooth

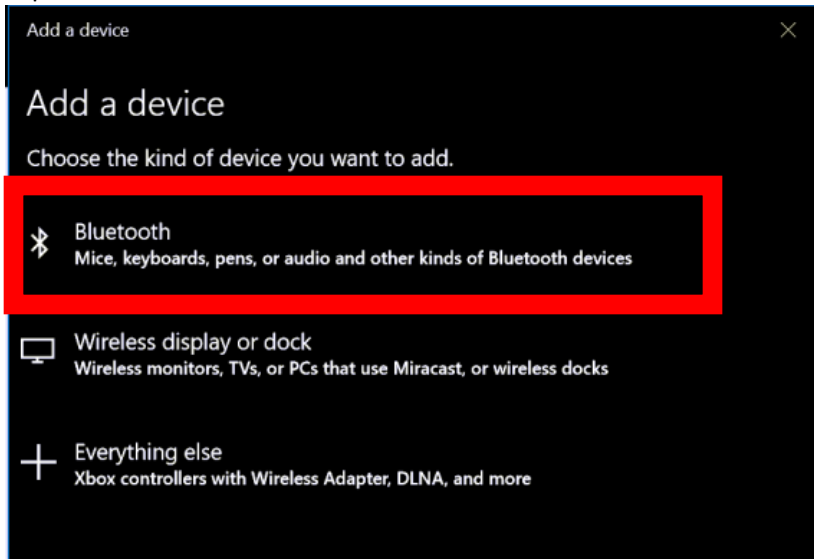

15. Hold down the Power button on the keyboard for 5 seconds until the lights flash orange and blue

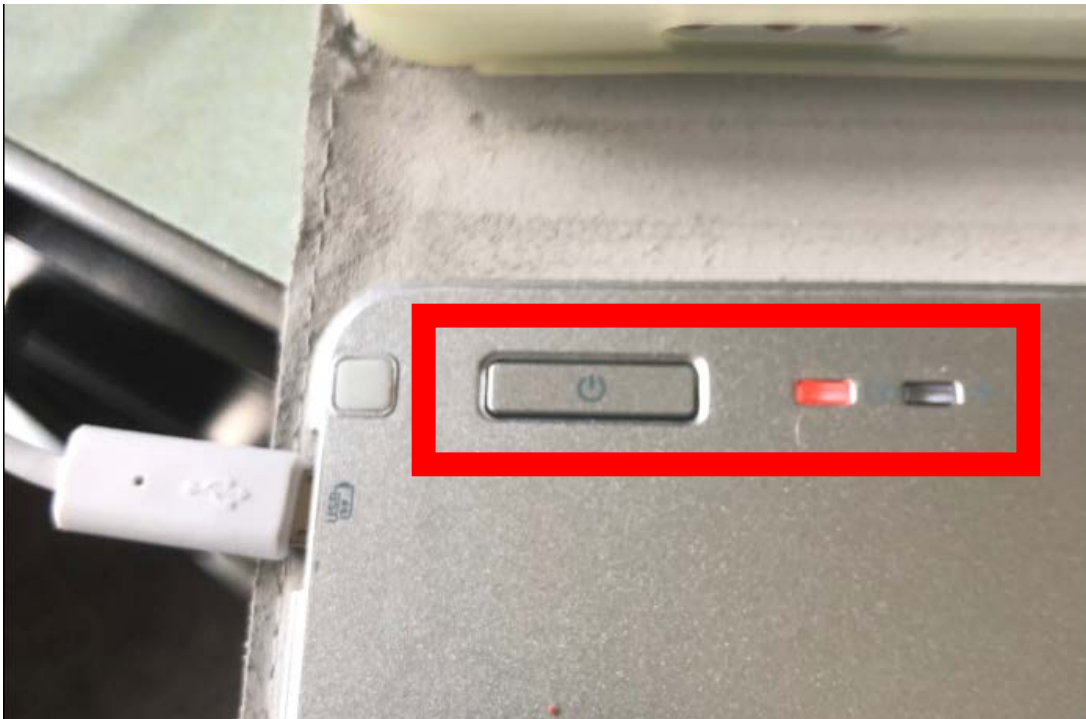

16. Tap 'Acer Iconia W700 Bluetooth Keyboard' when it appears (may take a few moments)

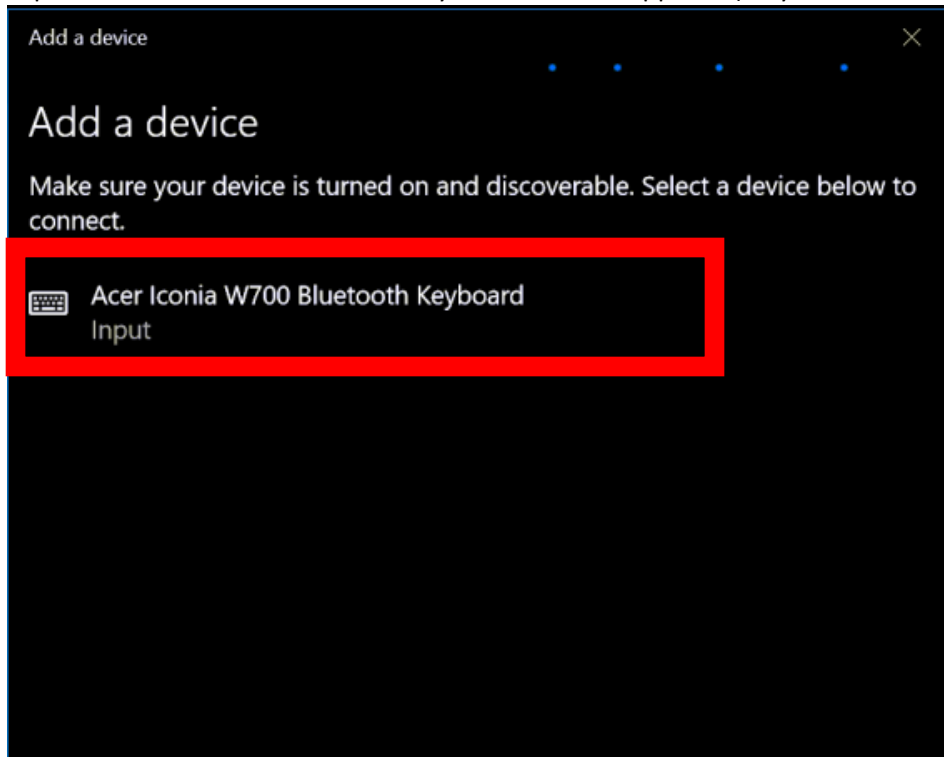

17. You will be asked to enter a PIN number. Use the keyboard to enter the PIN number (*your keystrokes will not be shown so enter these numbers carefully*) and hit Enter.
18. The keyboard is now ready to be used with your Acer tablet